

Electric 55 Gal. Drum & Tote Pump

Model No. DM-55ODPS115 or 220

Pump Tube: PVC, Polypropylene, Kynar (PVDF) or 316SS

Specifications, Parts Views & Codes



Drum Pump Operation

This interchangeable drum pump drive is designed to interchange with any quantity or type of "DP" series pump tubes, DM-PP8339, polypropylene, DM-SS8339, stainless steel, DM-KY8339, Kynar. The universal electric open, drip proof motor operating specifications are 825 watt, (1.1 Hp) 115 volt, 60 Hz, or 220 volt, 50 Hz. Includes on/off switch at handle grip for safer handling with thermally protected, manually resettable overload release and drop-in cartridge brush system. A variable speed version is available. Dry-run cycle not to exceed 5 minutes. Order and use **DM-55PWB-L** wall bracket to ensure safe storage. Use drum bung safety adapter **DM-55BA/PP** or **/SS** for secure tube mounting. **WARNING!** - Pump drive not suitable for flammable-hazardous duty or in areas with flammable materials.

Pump Tubes

The pump tube Materials of Construction (MOC's) are PVC, polypropylene, Kynar (PVDF-polyvinylidene fluoride), stainless steel (316SS) and Hastelloy C (HC). Select the most suitable pump tube for your application(s) considering foremost, 1) the chemical compatibility with the fluid being pumped, 2) the material thickness and last but not least, 3) liquid volatility. A "High-Head" HH version of these pump tubes is available, increasing both the head (height) and thickness capacity of the pump.

Applications & Examples of Liquids Pumped

A light, easily handled, high performance pump for most types of thin-bodied, slightly viscous, aggressive and non-flammable liquids. Chemicals, cleaners, concentrates, corrosives and many liquid compounds compatible with the MOC's listed above.

Operating Data

Flow rate: up to 29 - 38 Gpm
Delivery head: 35 ft., (HH [Hi-Head] >75 ft)
Temp. range: up to 132° F

Viscosity range: <750 cps, (HH -1500 cps (centipoise)
Material density: 1.8, HH - 0.80, Specific gravity
Pump Assembly Weight: 12 - 17 lbs. depending on components

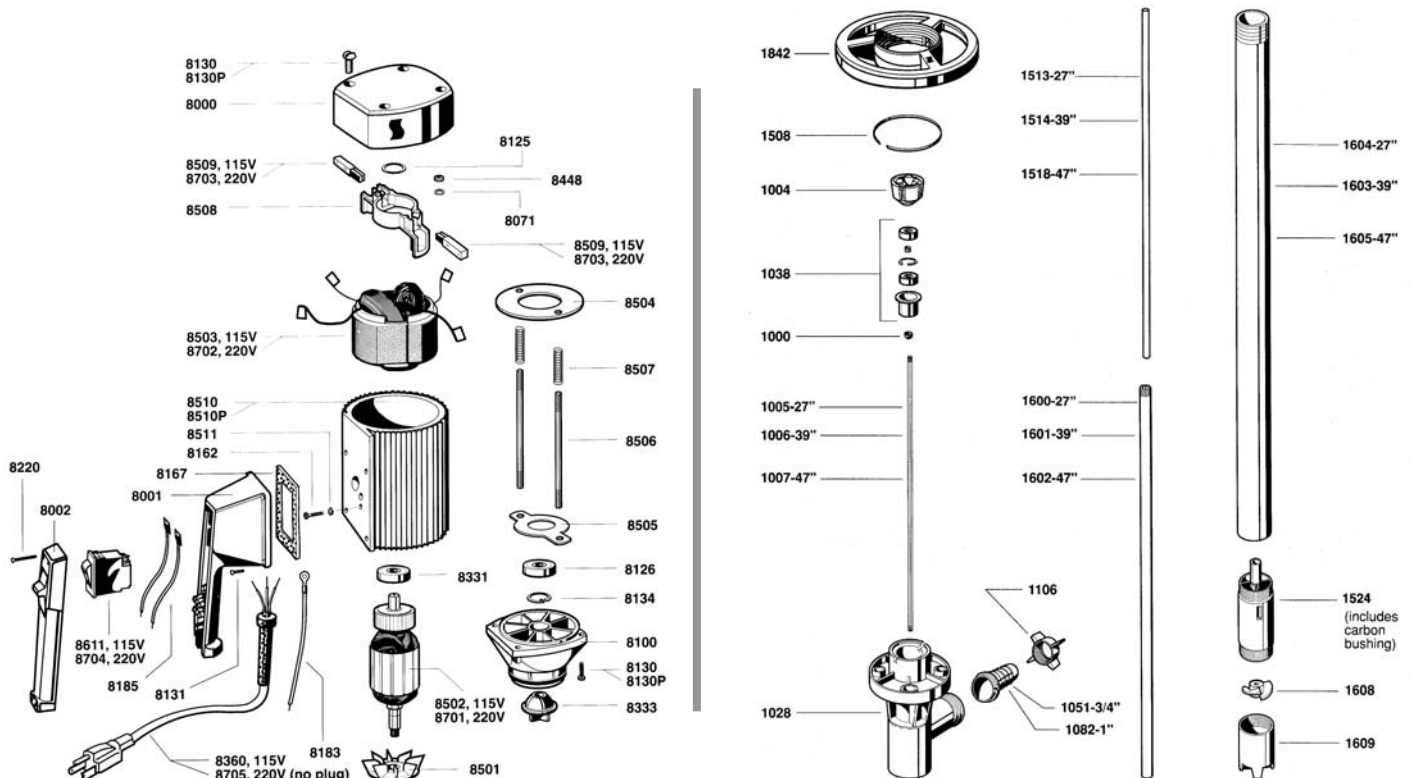

DM-55ODPS115/220 Drum Pump Drive

DM-PP8339, DM-SS8339, or DM-KY8339 Pump Tube

Parts List • DM-ODPS110 or 220 Pump Drive

DM-ODPS open motor should not be used to pump flammables or in areas where flammable materials are being used. Read, understand operating instructions before operating pump. Prices subject to change without notice. Made in USA. *Interchangeable Pump Drive Part

825 WATTS, 1 PHASE, 50 or 60 CYCLE

Part Number, 110 VAC	Description
8000*	Motor cover
8001*	Switch housing
8002	Switch cover
8071*	Lock washer
8100*	Lower housing
8125*	Wave washer
8126*	Ball bearing
8130*	Screw
8130P	Screw for plastic housing
8131*	Screw
8134*	Snap ring
8162*	Ground screw
8167*	Gasket
8183*	Earthing lead
8185*	Lead
8220*	Screw
8331*	Ball bearing
8333*	Motor coupling
8360*	Power cord w/strain relief, 115V
8448*	Hexagon nut
8502	Armature, 115V
8503	Stator, 115V
8504	Guide disc
8506	Rod connector
8507	Pressure spring
8508	Brush holder
8509	Carbon brush, 115V
8510	Motor housing
8511	Star washer
8512	Fan
8611	Overload switch, 8.5 amp, 115V
Part Number, 220VAC, IP-44 enclosure	
8167LVR	Gasket, low voltage release
8701	Armature, 220V, open
8702	Stator, 220V, open
8703	Carbon brush, 220V
8704LVR	Overload switch, 5 amp, 220V, low voltage release
8705	Power cord, 220V, no plug

Optional Accessories:

DM-55PWB-L, pump wall safety storage bracket, vinyl coated steel
 DM-55DP0150/SK, pump service kit with brushes, impellers, bearings, couplings, etc.
 DM-55DPFM, DP flow meter, 4-31 Fpm, 59 Psi, Accur: +/- 1%, 1" Npt Port
 Hand Dispensing Nozzles (see below)



DM-85HFR Series Nozzles
Polypropylene, SS, Viton



DM-700HFR Series Nozzles
AL, Brass or SS, Viton or TFE



DM-800HFR Series Nozzles
316 Stainless steel & Teflon



DRUM-MATES® pump and mixer equipment assemblies are supplied as components, each sold separately. Ask for literature on DRUM-MATES® drum/tote mixers, drum tumblers, drum/tote pumps & hand nozzles. DRUM-MATES® Inc., Liquid Processing Equipment Div., Tel: 609-261-1033, Fax: 609-261-1034